



## MEDIA RELEASE

### **Jewel Changi Airport blossoms with its inaugural floral festival – Jewel Blooms: Splendours of Singapore**

*A 10-day festival with floral displays, a floral competition for aspiring young florists, flea market and free workshops*



**Singapore, 31 August 2023** – This September, visitors to Jewel Changi Airport (Jewel) can embark on a visual journey through Singapore’s rich tapestry as the multi-faceted lifestyle destination showcases an exquisite collection of 10 floral displays by Singapore’s floristry talents, with each a botanical ode to Singapore’s story. In its first-ever event dedicated to the enchanting world of plants and flowers, **Jewel Blooms: Splendours of Singapore** will be a vibrant avenue for fostering creativity and growing connections within the local community through flowers. Botany lovers of all ages can admire captivating blooms and engage in a series of floral-themed activities such as workshops and marketplace activities during the floral festival which runs from 1 to 10

September 2023. For the first time, Jewel will also be holding the Youth Floral Cup, a floral design competition for budding florists between the ages of seven and twelve.

### **A feast for the senses: Blossoming displays of creativity**



*Floral display by Berlinda Tan: “Resonance of the Past: A Contemporary Symphony of Singapore’s Legacy” features the former National Theatre of Singapore with its iconic diamond-shaped façade and crescent-shaped bowl fountain.*



*Floral Display by Evelyn Lee: “Graceful Beauties: The Allure of Orchids” adopts the use of an Ikebana arrangement that is a fusion of orchids and peranakan styles.*

Putting the spotlight on local florists, visitors can see original floral installations from the renowned floral designers including Anson Low (AIFD<sup>1</sup>, CFD<sup>2</sup>), Christopher Lim (AFID, CFD, Riji), Damien Koh (PFCI<sup>3</sup>, AIFD, CFD) and more. A total of 10 artworks (each measuring 1.5 metres in width and height), inspired by different facets of Singapore such as its history, culture, food and national flower, are displayed at the Shiseido Forest Valley and Canopy Park.



---

<sup>1</sup> American Institute of Floral Designer

<sup>2</sup> Certified Floral Designer

<sup>3</sup> Professional Floral Communicators – International

*Floral display by Felicia Kang: “Kueh Kueh Memories” is inspired by one of local iconic peranakan kuehs – the rainbow lapis.*

*The iconic masterpiece of Jewel Changi Airport by Anson Low with his interpretations of the HSBC Rain Vortex.*

One of the floral displays, designed by Anson Low, is a take on his interpretation of the world’s tallest indoor waterfall. With a colour palette of blues, whites and greens, mimicking nature and water, and incorporating flowers such as orchids, larkspur, flamingo lilies and sea hollies, this will be a visually stunning re-creation of the HSBC Rain Vortex.



*Floral Couture by ITE College Central (NITEC in Floristry) year 1 students: A wearable floral art masterpiece featuring luscious blooms, elegant orchids and a geometric pattern that perfectly represents Jewel Changi Airport’s roof façade.*

There will also be three special displays created by a group of Year 1 students from ITE College Central, *Nitec* in Floristry. One of these include a piece of wearable art combining fashion and nature, the design draws inspirations from elegant flowers and orchids as well as the iconic geometric pattern of Jewel’s façade.

### **Nurturing floral artistry in the younger generation**

Aimed at cultivating the next generation of florists in our community, the Youth Floral Cup is a junior floral competition for primary school students. There are two categories – Category A for students between Primary 1 and 3, and Category B for students



between Primary 4 and 6. The young contestants will have one hour to construct a floral display using a surprise box of fresh flowers and foliage that will be provided. After the competition, all the finished artworks will be displayed at Level 1 (near Luke's Lobster) from 2 to 7 September. Winners will be crowned at an awards presentation ceremony held on 2 September.

### **Uniting plant lovers and enthusiasts**

For plant parents keen to enhance their green spaces, or anyone wishing to get acquainted with gardening, this is a chance to get started with activities ranging from a plant swap, flea market selling a variety of plants, flowers, and horticulture tools, and a series of free talks and workshops.

Join fellow plant enthusiasts at the **Plant Swap**, where participants can exchange and discover new additions to their personal plant collections. Then head to the **Jewel Blooms Marketplace** at the Basement 1 Atrium to find twelve stalls run by local artisans, plant nurseries, and eco-friendly vendors and shop for new plants and tools. There is also a line-up of talks and workshops where experts will share insights on cultivating leafy greens and creating flower arrangements at home, to inspire budding florists.

For more details on date, time and venue of the plant swap, marketplace and workshops, visit <https://www.jewelchangiairport.com/en/Jewel-Blooms-2023.html>.

**James Fong, CEO of Jewel Changi Airport Development**, said “Jewel and Changi Airport are widely known for our world-class gardens and nature-inspired spaces. Building on this signature, Jewel Blooms aims to become another distinguished Jewel event that can bring together the community – whether it’s highlighting the works of local artists, inspiring budding florists of tomorrow, or creating a space for plant lovers to interact and share tips - through a common love for flowers and plants.”

For high resolution images, download [here](#).

## **About Jewel Changi Airport ([www.jewelchangiairport.com](http://www.jewelchangiairport.com))**

Jewel Changi Airport (Jewel), a world-class multi-dimensional lifestyle destination in Singapore, is developed by Jewel Changi Airport Trustee Pte. Ltd., a joint venture by Changi Airport Group and CapitaLand. Jewel is located at the gateway of Changi Airport.

Designed by world-renowned architect Moshe Safdie, Jewel features a distinctive dome-shaped facade made of glass and steel, making it an iconic landmark in the airport's landscape. At 135,700 sqm in size, it offers a range of facilities including airport services, indoor gardens and leisure attractions, retail and dining offerings as well as a hotel, all under one roof. These unique offerings in Jewel are envisaged to enhance Changi Airport's appeal as a premier air hub.

### **Follow us on social media:**

Facebook: <http://www.facebook.com/JewelChangiAirport>

Instagram: <https://www.instagram.com/jewelchangiairport/>

LinkedIn: <https://www.linkedin.com/company/jewel-changi-airport/>

Tiktok: <https://www.tiktok.com/@jewelchangiairport>

Xiao Hong Shu: <https://bit.ly/jewelxiaohongshu>

Hashtag your posts with: #JewelChangiAirport

## **JEWEL BLOOMS – SPLENDOUR OF SINGAPORE**

Floral Display at Shiseido Forest Valley

**“Resonance of the Past: A Contemporary Symphony of Singapore’s Legacy”**

***Berlinda Tan***



Inspired by the former National Theatre of Singapore, this contemporary floral installation recreates the diamond shaped façade and crescent-shaped bowl fountain, evoking nostalgia for those who once visited the cultural centre.

The crescent moon-shaped fountain bursts with vibrant floral hues, which compliments the diamonds representing democracy, justice, peace, progress, and equality.

Singapore’s city-in-a-garden vision and diverse cultural tapestry are embodied through the fountain which is flanked by the multi-coloured structures. The combination orchestrates a seamless harmony between heritage and modernity, honouring Singapore’s colourful legacy.

## Floral Display at Shiseido Forest Valley

### **“Graceful Beauties: The Allure of Orchids”**

***Evelyn Lee***



Orchids hold deep cultural and symbolic meanings in many societies. For centuries, they have been prized as symbols of love, beauty, and luxury. The Peranakans, or Straits Chinese, with their vibrant culture, typically use orchids, or orchid motifs, in their aesthetics, everyday rituals, and celebrations. Intricate batik fabrics and traditional kebaya blouses worn by Peranakan women often feature orchid designs, showcasing the elegance and sophistication associated with these flowers.

This floral display also features the Japanese’s concept of wabi-sabi, which embraces imperfection, transience and the beauty of the natural world. To reflect this in the floral display, the designer has adopted the use of an Ikebana arrangement that fuses orchids and peranakan styles.



## Floral Display at Shiseido Forest Valley

### “Kueh Kueh Memories”

**Felicia Kang**



Vibrant colours, a painter's dream,  
Sweet aroma, like heaven's cream.  
Layer by layer, we savour with glee,  
Every story, we laugh and tease.  
Kueh Lapis, a culinary delight,  
A masterpiece, a joyful sight.  
Here's mama's love, in every bite,  
Her magic touch, making it just right.

This floral installation is inspired by one of the iconic peranakan kueh-kueh (a Malay word for sweet snacks) that you can find in Singapore – the Rainbow Lapis.



Floral Display at Shiseido Forest Valley

**“Symphony of Colours”**

***Peggy Loh***



In this mesmerising display of floral artistry, the vibrant and culturally rich landscape of Singapore's racial harmony comes to life through a colourful Ikebana arrangement. This exquisite masterpiece, by skilled Ikebana artist, Peggy Loh, serves as a visual ode to the nation's multicultural social fabric and the coexistence of its diverse communities.

At the centre of the Ikebana stands a singular vase, symbolising Singapore as a melting pot of different cultures and races where each element of the arrangement is thoughtfully chosen to represent the unique identity and contributions of different racial and ethnic groups living in the garden city.

The Ikebana's composition is skilfully balanced, emphasising the equal importance of each element and the need for harmony among them. The arrangement exudes a serene aura, inviting viewers to pause and appreciate the delicate balance that Singapore has achieved through its commitment to racial harmony.

## Floral Couture

### ITE College Central (NITEC in Floristry)



The NITEC floristry students have been invited to create a floral art masterpiece at Jewel Changi Airport where they unleashed their creativity through the design of wearable floral art. These students sought to transcend the boundaries of fashion by creating a delicate masterpiece that balances nature's exquisite beauty with the elegance of fashion. The design features luscious blooms, elegant orchids and a geometric pattern that perfectly represents Jewel's roof façade.



Floral Installation at West Canyon

**“Merlion’s Blooms: Progress Through Petals”**

***ITE College Central, Nitec in Floristry x RIFA***

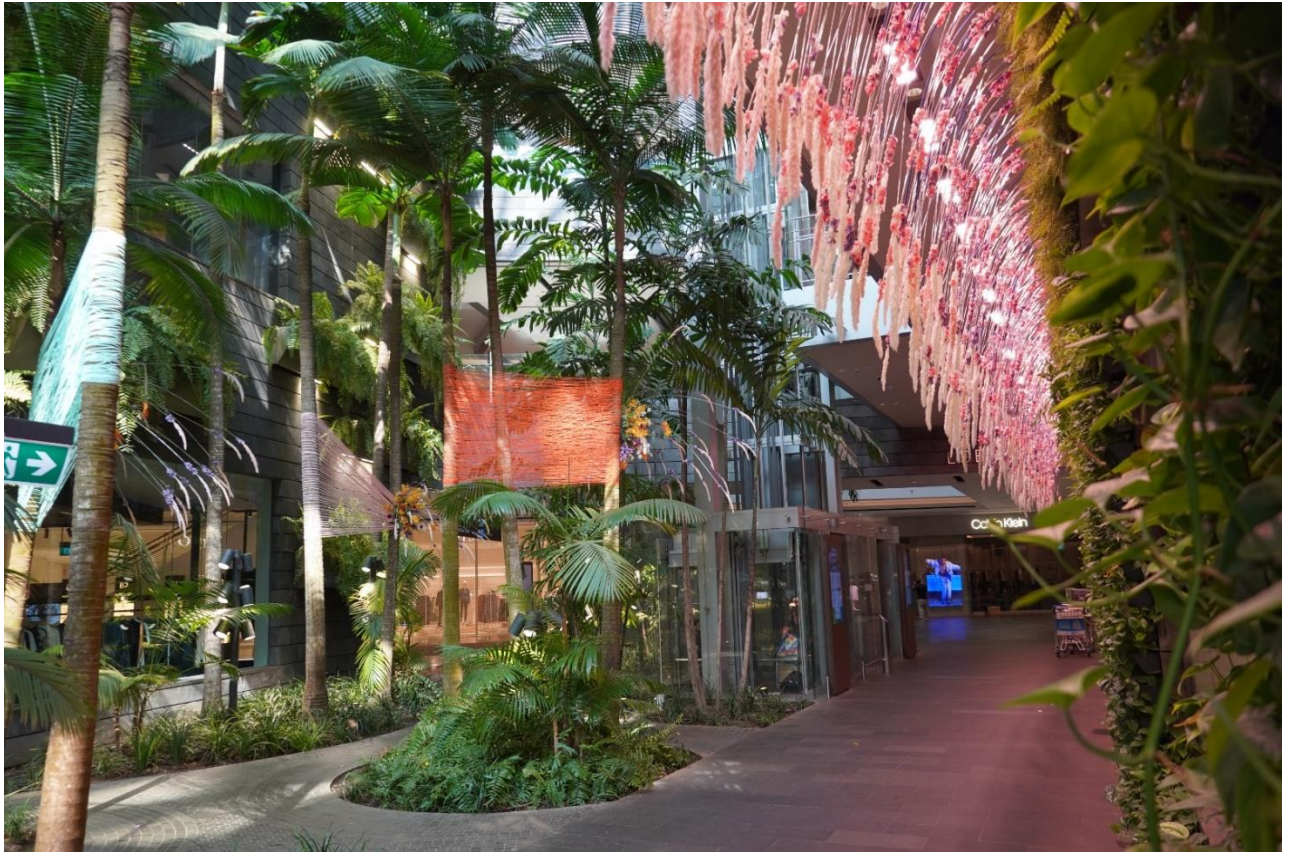

Inspired by the timeless Merlion, this floral display captures its flowing movement. Acrylic elements curve gracefully, echoing the fountain's form.

The many acrylic pieces that flow from the green walls represents the ever-flowing passion of our young generation. This also channels the spirit of “Majulah Singapura”, progressing onwards.

The palm tree trunks delicately adorned with orchid blossoms, this creation pays homage to Singapore's rich tradition of orchid hybridisation. The intricate design reflects our ongoing dedication to nurturing meaningful connections through the language of flowers.



## **Floral Installation #1 at Petal Garden**

**The Iconic masterpiece at Jewel Changi Airport**

***Anson Low***

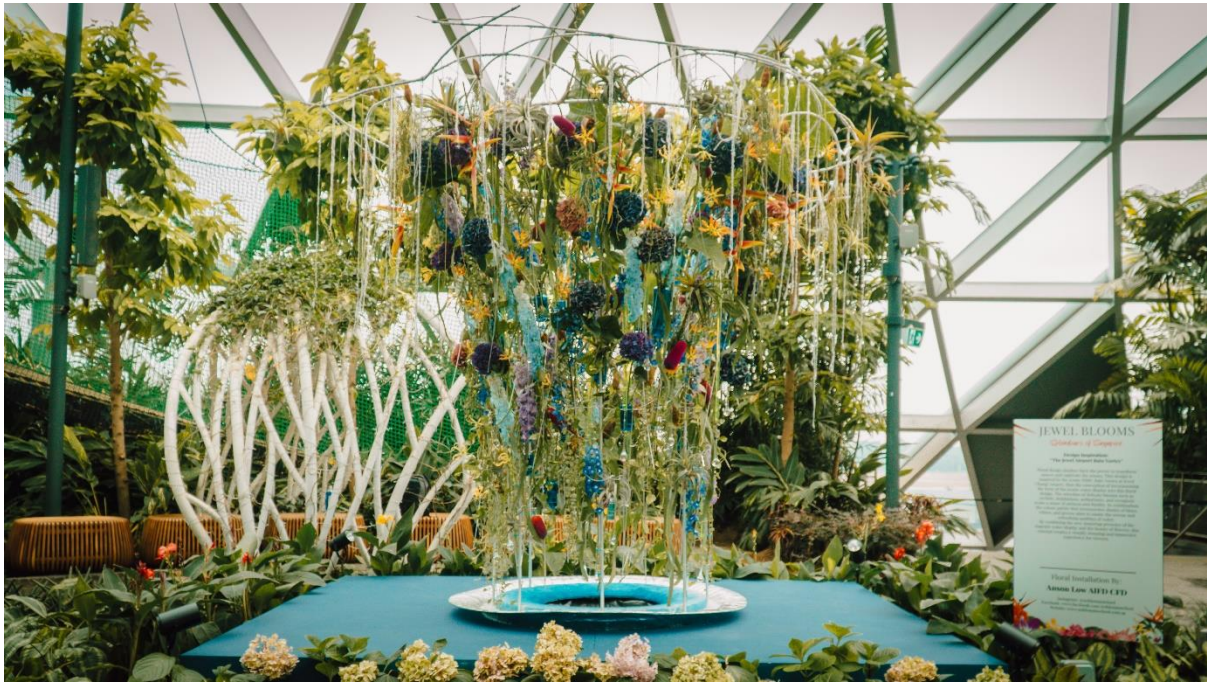

Floral design displays have the power to transform spaces and captivate the senses. This design is inspired by the iconic HSBC Rain Vortex at Jewel Changi Airport, thus incorporating the form of the world's tallest indoor waterfall into this floral design. The selection of delicate blooms such as orchids, delphinium, anthuriums, and eryngium evokes a sense of airiness and fluidity. In combination, the colour palette that incorporates shades of blues, whites, and greens aims to mimic the serene and refreshing qualities of water.

By combining the awe-inspiring presence of the majestic water display and the beauty of flowers, this display creates a visually stunning and immersive experience for viewers.

## Floral Installation at Petal Garden

### **“Moving Up”**

**Christopher Lim**



In this captivating Sogetsu arrangement by Christopher Lim, the delicate art of flower arranging comes alive with a profound representation of Singapore's journey towards progress and growth. Drawing inspiration from the nation's spirit and determination, this display masterfully weaves a story of "Singapore Rising" using the symbolism of red and white bamboo. Bamboo has long been symbolic of durability, strength and resilience through adversity.

As the eye moves upward in the arrangement, one can't help but notice the deliberate upward trajectory, aptly named "Moving Up." This aspect of the design celebrates Singapore's continuous pursuit of excellence, ever-reaching for greater achievements. The upward lines in the ikebana reflect the nation's determination to rise above and reach new heights.

Through the skilled hands of Christopher Lim, this ikebana arrangement encapsulates the essence of Singapore's spirit - a nation that embraces its past, celebrates its diversity, and moves forward towards a brighter future.



## Floral Installation at Petal Garden

**“Raised”**

***Damien Koh***



From our humble beginnings as a fishing port came the inspiration for this display. A sampan motif structure is raised up representing our path from then to this little red dot we all know. The boat-like structure carries each sphere - representing the different ethnic groups, religion, cultures and languages - a metropolitan city holding, mixing, melting and sharing, as we are raised up together.



Floral Display at Source Pool

**“Rooted Harmony”**

***ITE College Central, Nitec in Floristry x RIFA***



This captivating floral masterpiece draws inspiration from Singapore's coastal mangroves – vital ecosystems safeguarding marine habitats. These natural wonders prevent erosion, mitigate tides, and serve as carbon sinks, maintaining our environment's natural balance.

Mirroring mangrove trees' resilient stilt roots, this installation also pays tribute to past Singaporean generations. Like how these roots supporting the muddy terrain, they symbolize the foundation for future generation to aspire higher.

This installation truly depicts that with a strong foundation, beauty emerges.